

# SOPRANATURE

NATURAL

ROOFING



SOLUTIONS

**SIMPLE, ECONOMIC ROOF GARDENS**



## Sopranature: Green roofing at its finest

In 1989, Soprema launched a new roofing concept called Sopranature.

Today, Soprema Sopranature is a world renowned green roofing supplier and solutions provider. There are over 700 successful Sopranature projects, incorporating 300,000m<sup>2</sup> of international green roofing.

In the UK, Sopranature is a total green roofing service. Simply decide upon the type of vegetation that will suit the roof in question, and a value engineered specification will be tailored complete with standard detail drawings, warranty information, a Soprema approved green roof installer listing (again, tailored to logistics and requirements) and waterproofing product data (including BBA certification). The simple process is started by completing page four of this brochure.



Lande



Green



Tailored Ivy



Tundra

## Intensive or Extensive Vegetation?

Green roofing can be classified into two elementary types.

Firstly, there is intensive roofing, where use of the roof becomes frequent and can therefore be considered an actual garden. The roof will need more care at its design stage, with careful consideration being given to planting, insulation, the growing medium, static load bearing, maintenance and cost. An intensive green roof will also need regular maintenance and irrigation. There are two types of intensive Sopranature systems that are particularly suited to the UK's climate: Lande (a landscaped appearance) & Green (a lawn appearance).

Secondly, there is extensive roofing.

An extensive roof is not used as a garden, but as a green roof for aesthetic, ecological or protection reasons. The vegetation used within an extensive roof is extremely resilient, providing a lush carpet-like foliage. An extensive green roof will only require minimal maintenance and irrigation will only need to be addressed in drought conditions. There is a single type of extensive Sopranature system particularly suited to the UK's climate: Tundra (a tundra appearance), which is the UK's most popular and cost effective Sopranature system. Dependent on climate, an extensive system can be tailored to include species of the clients choice (i.e. Ivy). Extensive Sopranature roofing can also be lightweight, which actually allows a green roof to be considered upon timber and metal roof decking as well as traditional concrete structures. This offers a client greater flexibility in design and cost analysis of projects.

### Coverage Method

### Flourish Timescale

**Seed & Cuttings**

**3 months to a year**

**Plants**

**3 to 6 months**

**Pre-cultivated rolls**

**Immediate**

**Pre-cultivated turf**

**Immediate**

For projects incorporating tailored plants, cuttings and seeds, Sopranature guarantees a minimum 60% vegetation coverage within 12 months of green roof completion.

“In specifying Soprema SBS membranes, we will back your judgement with extensive warranties and additional insurance backing when installed via the UK’s approved contractor network.”



## Soprema Sopracover Warranty Scheme

A Soprema Sopracover warranty offers major advantages over ‘similar’ warranties.

### These are:

Backing by a Major Insurance Company in the City of London, actionable and bound by U.K. law.

Premium is paid by Soprema and cover is maintained if they or the Contractor cease to trade.

Reimbursement is not restricted to the original cost of the project.

Insurance cover is transferable to any new building owner.

An individual warranty is issued for every project, complete with products listings.

There are no compulsory maintenance agreements required from the installer or costs relating to the warranty from the beneficiary.

Payment of the cost of Materials and Labour to rectify any failure in the Soprema waterproofing products or their design and resultant damage to the roofing system.

Reimbursement of consequential damage to a maximum of £800,000 in the case of a proven design or manufacture defect in Soprema products.

Product liability with a limit of indemnity (any one event) of £5,000,000.

### The Sopracover Premium Total Roof Guarantee

Soprema is also proud to offer the Sopracover Premium Total Roof Guarantee. For a small premium, Soprema takes full responsibility for the roof. An individual AXA insurance policy will cover the Soprema **specification, system design**, materials, labour and consequential loss.

**For more information on this Superlative guarantee, please contact the Soprema Consultancy team on (023) 9225 6480.**

## Sopranature Specifics

The following pages show universal Sopranature detail drawings that include specifications. However, It is always best to address each Sopranature roof on a project by project basis. By completing and returning the following check-list, Soprema staff can value engineer a Sopranature roof to exact requirements.

### Identification

Contact name: .....

Project name: .....

Architect name: .....

Building owner: .....

Project address: .....

### Information

- New work or renovation?
- In case of renovation, please describe the existing waterproofing system:
- Area (per m<sup>2</sup>):
- Decking type:
- Insulation requirements:
- Is the roof accessible to pedestrians?
- Roof height:
- Maximum permissible load (per m<sup>2</sup>)
- Slope:

### Environment

- Are there buildings overlooking the roof?
- If yes, what is their distance and height?
- Do overlooking buildings have a direct view of the roof?
- Orientation of the building (north, south etc):

### Particulars

- Natural aspect required (Toundra, Lande, Green):
- Preferred type of application (sowing, planting, pre-cultivated rolls)
- Any tailored/customised requirements?
- Access to site during works
- (easy, average or difficult):

**Alternatively, please contact Soprema on (023) 9225 6480 to arrange a personal consultation.**





### Warm Roof Specifications

- ❑ **Deck:** Any deck accepted provided it withstands the load of the whole system (defined by a preliminary study carried out by the Sopranature department for each project).
- ❑ **Vapour Barrier:** Soprema Mammoth Atlas GS4, 4mm elastomeric SBS polymer modified, heavy duty reinforced, aluminium core vapour barrier. Fully waterproof and airtight membrane.
- ❑ **Insulation:** Soprema Sopratherm CFC/HCFC and zero ozone depletion rated rigid polyurethane Insulation with 150kpa compression at 10%. Thickness to achieve 0.25w/m<sup>2</sup> thermal value in accordance with current part L building regulations (approx. 90mm). Insulation bonded with Soprema Soprabond polyurethane adhesive.
- ❑ **Waterproofing System:** Soprema Aerisol Flam, 1mm thick, vapour control sheet followed by Soprema Sopralene Flam 180, 4mm SBS elastomeric, polyester reinforced underlay and Soprema Sopralene Flam Jardin AR, 4.5mm thick SBS elastomeric, polyester reinforced capsheet with root preventative additive.
- ❑ **Sopranature System:**
  - a) **Soprema Sopradrain:** A reservoir board (50mm), loose laid to create free flowing filtration of water to outlets.
  - b) **Soprafiltre Fleece:** Laid on top of Sopradrain to prevent fine particles from clogging the drainage layer.
  - c) **Sopraflor Substrate:** Exclusive soil mix designed and manufactured to achieve optimum water retention, permeability, density and resistance to erosion to support lush vegetation over the entire roof.
- ❑ **Vegetation:** An integral part of the system and has been designed for its ability to adapt to extreme weather conditions. Spreading plants are used, such as, annuals, biennials, and perennials. When re-generating themselves, they spread naturally over the substrate. 2 aspects are available:
  - a) **Tundra:** The UK's current most popular choice comprising of carpet like vegetation with succulent plants (sedum) predominating (30-120mm thick inc. Sopraflor substrate)
  - b) **Lande:** Colourful and lush vegetation: perennial plants, shrubs, conifers and heathers (200-350mm thick inc. Sopraflor substrate, vegetation height 100-1500mm). Note: automatic sprinklers are recommended for Lande.

The Sopranature system is 3 times lighter than traditional green roofing with maintenance requirements very low (yearly check up)

**NBS specification format available on request.**



## Sopranature:

Lightweight extensive green roofing system (low maintenance)



## Reinforced System

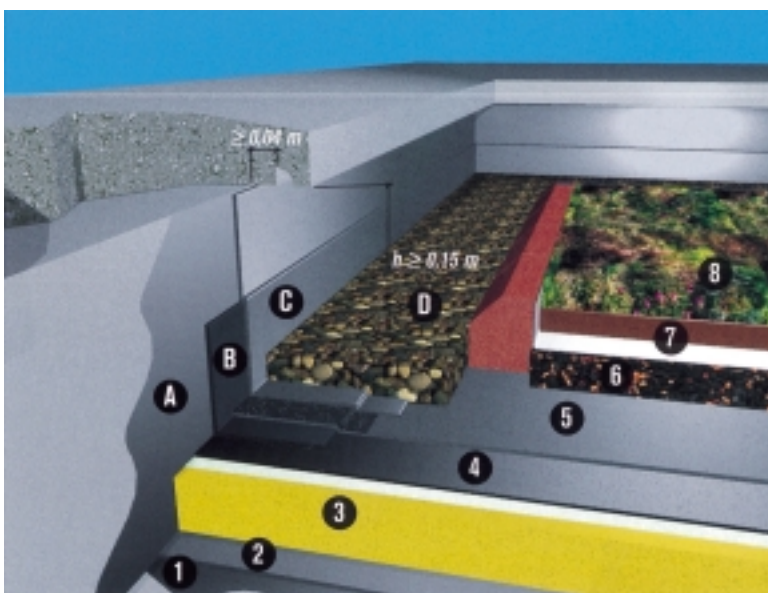

1. Elastocol 500 Primer
2. Mammoth Atlas GS4
3. Insulation
4. Sopralene Flam 180/Aerisol Flam
5. Sopralene Flam Jardin
6. Drainage
7. Filter
8. Substrate + Vegetation

### Upstands:

- A. Elastocol 500 Primer
- B. Sopralene Flam 180-40
- C. Sopralene Flam Jardin
- D. Edge Protection (gravel) if required

## Soprema Recommendations

**SOPRANATURE** roof top vegetation is a concept which offers numerous advantages:

- Lightweight, thin vegetation cover
- Self regenerating plants
- Minimal maintenance
- Little additional load on building structure.

A study is carried out for each project in order to select the right plants according to the climate, the slope, the additional load permitted...etc

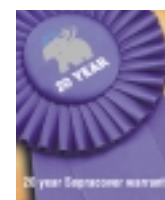

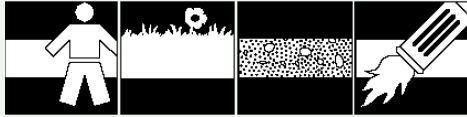

### Warm Roof Specifications

- ❑ **Deck:** Reinforced concrete, designed to support weight of proposed roof landscaping (defined by a preliminary study carried out by the Sopranature department for each project).
- ❑ **Primer:** Elastocol 500, SBS elastomeric bituminous primer, applied fully to substrate.
- ❑ **Vapour Barrier:** Soprema Mammoth Atlas GS4, 4mm elastomeric SBS polymer modified, heavy duty reinforced, aluminium core vapour barrier. Fully waterproof and airtight membrane.
- ❑ **Insulation:** Soprema Sopratherm CFC/HCFC and zero ozone depletion rated rigid polyurethane insulation with 150kpa compression at 10%. Thickness to achieve 0.25w/m<sup>2</sup> thermal value in accordance with current part L building regulations (approx. 90mm). Insulation bonded with Soprema Soprabond polyurethane adhesive.
- ❑ **Waterproofing System:** Soprema Aerisol Flam, 1mm thick, vapour control sheet followed by Soprema Sopralene Flam 180, 4mm SBS elastomeric, polyester reinforced underlay and Soprema Sopralene Flam Jardin AR, 4.5mm thick SBS elastomeric, polyester reinforced capsheet with root preventative additive.
- ❑ **Green Roof System:**
  - a) **Soprema Sopradrain:** A reservoir board (50mm), loose laid to create free flowing filtration of water to outlets.
  - b) **Soprafiltre Fleece,** laid on top of Sopradrain to prevent fine particles from clogging the drainage layer.
  - c) **Soil Substrate,** 300mm minimum. Soil as required by landscaping contractor to suit the variety of planting and growing mediums selected for the project. Depths of soil can vary to suit inclusion of larger, more established shrubs, trees and plants. Can be treated as an actual garden with a combination of hard and soft landscaping to create specific environments.
  - d) **Irrigation:** As required to suit chosen planting varieties.
- ❑ **Vegetation:** As specified by the landscaping contractor.

**NBS specification format available on request.**

**Green Roofs -** Intensive - regular maintenance and irrigation, greater soil depth for planting of established varieties, new work, concrete deck with insulation.



### Reinforced System

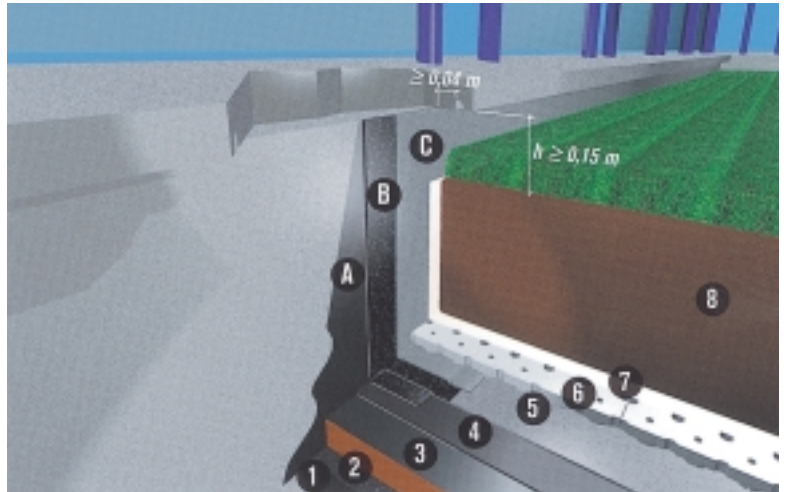

1. Elastocol 500 Primer
2. Mammoth Atlas GS4
3. Insulation
4. Sopralene Flam 180/Aerisol Flam
5. Sopralene Flam Jardin
6. SOPRADRAIN drainage
7. SOPRAFILTRE fleece
8. Soil

#### Upstands:

- A. Elastocol 500 Primer
- B. Sopralene Flam 180-40
- C. Sopralene Flam Jardin

### Soprema Recommendations

- Above 1 metre soil, upstands should be protected from shrinkage hazards.
- Choose the SOPRANATURE\* light green roof system when the deck cannot withstand heavy soil or when maintenance is difficult.

\* see page 5



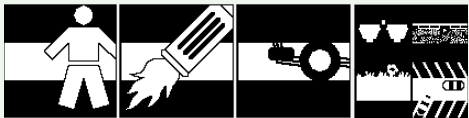

### Warm Roof Specifications

- ❑ **Deck:** Reinforced concrete, designed to support weight of proposed roof landscaping (defined by a preliminary study carried out by the Sopranature department for each project).
- ❑ **Primer:** Elastocol 500, SBS elastomeric bituminous primer, applied fully to substrate.
- ❑ **Vapour Barrier:** Soprema Mammoth Atlas GS4, 4mm elastomeric SBS polymer modified, heavy duty reinforced, aluminium core vapour barrier. Fully waterproof and airtight membrane.
- ❑ **Insulation:** Soprema Sopratherm CFC/HCFC and zero ozone depletion rated rigid polyurethane insulation with 150kpa compression at 10%. Thickness to achieve 0.25w/m<sup>2</sup> thermal value in accordance with current part L building regulations (approx. 90mm). Insulation bonded with Soprema soprabond polyurethane adhesive.
- ❑ **Waterproofing System:** Soprema Aerisol Flam, 1mm thick, vapour control sheet followed by Soprema Sopralene Flam 180, 4mm SBS elastomeric, polyester reinforced underlay and Soprema Sopralene Flam Jardin AR, 4.5mm thick SBS elastomeric, polyester reinforced Capsheet with root preventative additive.
- ❑ **Paving:** Hydraulically compressed paving slab as specified by client (e.g. Marshalls Mooredale 600x600x50mm), laid on Soprema adjustable propriety paving support pads (40-67mm).
- ❑ **Planters:** Formed concrete, timber or galvanised metal containers with drainage holes approx 20mm high to perimeter sides at base at 75-150mm centres. (Note: consider specifying the planter sizes the same as the slabs i.e 1200x1200mm = 4 slabs) to aid the setting out of the scheme)
- ❑ **Green Roof System (to inside of planters):**
  - a) **Soprema Sopradrain:** A reservoir board (50mm), loose laid to create free flowing filtration of water to outlets.
  - b) **Soprafiltre Fleece:** laid on top of Sopradrain to prevent fine particles from clogging the drainage layer.
  - c) **Soil Substrate,** Soprema Sopraflor, exclusive soil mixed designed and manufactured to achieve optimum water retention., permeability, density and resistance to erosion.
  - d) **Vegetation to Planters:** As specified by the landscaping contractor/client to suit.

**NBS specification format available on request.**



## Green Roofs Combined with Terrace - New work, concrete deck insulation



### Reinforced System



1. Elastocol 500 Primer
2. Mammoth Atlas GS4
3. Torchtherm Insulation
4. Sopralene Flam 180/Aerisol Flam
5. Sopralene Flam Jardin

#### Upstands:

- A. Sopradere Primer
- B. Sopralene Flam 180-40
- C. Sopralene Flam Jardin

### Soprema Recommendations

It's quite common to find several types of waterproofing build-ups on the one terrace. The "Jardin" waterproofing systems provides a multipurpose solution in these cases, therefore allowing freedom for the client to add/remove/planters/soft landscaping to any location on the roof.

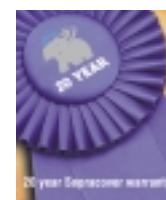

# Sopranature staff place great emphasis on value engineering



## Without compromising excellence, a cost effective green roof is tailored for you

The quality of our environment has been taking a more and more important role in urban life. Sopranature is a name of distinction in both new and refurbishment green roof construction.

Green roof conception and design possibilities are many and are easily installed upon offices, hotels, hospitals, schools and a multitude of commercial and industrial buildings.

As an experienced green roof producer and solutions provider, Sopranature will provide a roof with attractive and vibrant vegetation.

Sopranature is an award winning and complete green roof service. In Europe, Sopranature has been awarded the special prize in a prestigious building innovation competition and a gold medal for the Central School of Arts project, France.



Soprema SBS Roofing Limited

Soprema House

PO Box 52

Waterlooville

Hampshire

PO7 7YQ

Tel: 023 9225 6480

Fax: 023 9225 6510

e.mail: [soprema.sbs@btconnect.com](mailto:soprema.sbs@btconnect.com)

Web: [www.soprema.com](http://www.soprema.com)



Car park roof, Chiswick, UK



Garage semi-enterré à rigo  
Lettonie, France



Chineham incinerator, Basingstoke, UK



Admiral Lord Nelson school,  
Portsmouth, UK